

Bed Assembly Instructions

1. "Dryfit" the bedrails into the headboard and footboard.
 - a. Fit the pegs into the holes, "wiggle" back and forth until the pegs are completely in the holes and the rails are flush with the headboard and footboard

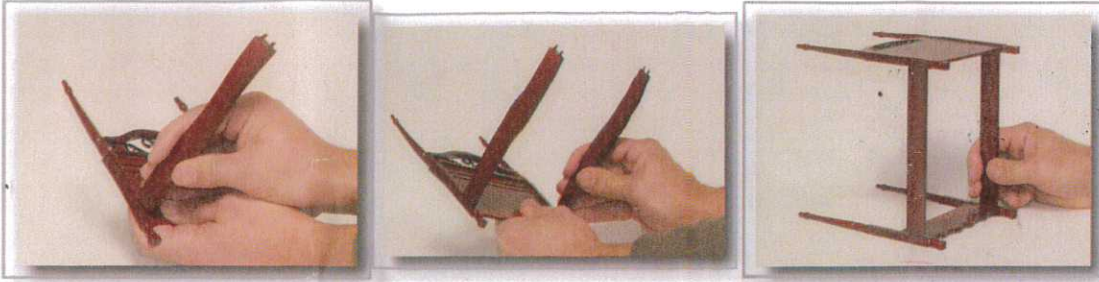

2. Disassemble and glue the bed frame
 - a. take the bed apart
 - b. apply a small amount of glue to each peg
 - c. reassemble the bed



3. To ensure bed dries square apply a weight to the bed rails
 - a. make sure all feet are touching the even base surface when you apply the weight
 - b. let the glue dry overnight



4. Reassemble the bedding frame and dust ruffle so the dust ruffle is evenly spaced on the bed, then slide the outer frame over the top of the bedding frame

